



**ACTUAL VIEW**



**Guildford, NSW**  
58/548-556 Woodville Road

**2** | **1** | **1** **true** =  
BED | BATH | CAR PROPERTY

Experience the privacy of your own top floor two bedroom apartment in this near new security complex. Overwhelmed with natural light, this gorgeous apartment is located at the rear of the complex making it very private, yet convenient to all amenities.

- = Two double sized bedrooms, both with built in wardrobes
- = One modern tiled bathroom
- = One security car space and storage cage
- = Gourmet open plan gas kitchen with dishwasher
- = Combined living and dining areas leading to a private balcony with fantastic district views
- = Internal laundry including dryer

**FOR SALE**

**Council Rates:** \$180/qtr (approx)  
**Water Rates:** \$150/qtr (approx)  
**Strata Rates:** \$590/qtr (approx)  
**Contact:** Michael Catalano  
 0449 878 376  
**Type:** Apartment  
**Land:** 95m2  
<http://www.trueproperty.com.au>

STORAGE  
CAGE

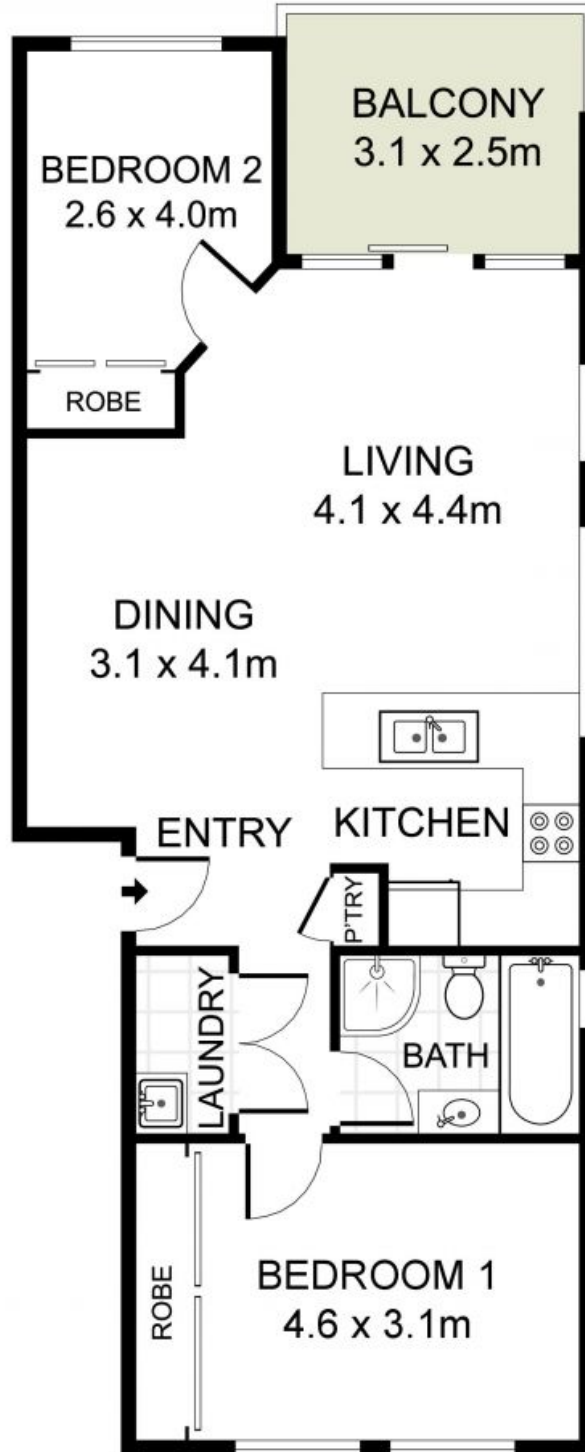
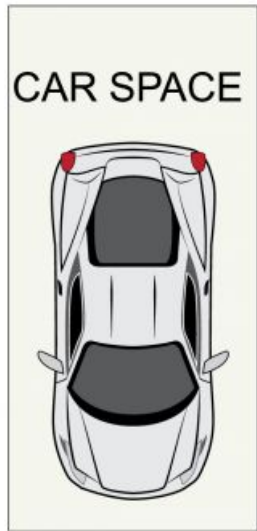

true =  
PROPERTY

58/546 Woodville Road, Guildford

DISCLAIMER: PLANS SHOWN ARE FOR PRESENTATION PURPOSES AND ARE NOT PART OF ANY LEGAL DOCUMENT. ALL MEASUREMENTS AND FIGURES ARE APPROXIMATE.

Plans shown are only indicative of layout. Dimensions are approximate.

**Guildford, NSW**  
58/548-556 Woodville Road