



222 Liverpool Road ASHFIELD NSW

= APPLICATION RECEIVED = Located in the heart of Ashfield comes the opportunity to secure this large retail space which has been home to some iconic businesses in the past. With an abundance of new development commencing or due for completion the opportunity to take advantage of this great amount of exposure for your business will not last long.

THE PROPERTY

- = Floor area approx. 132sqm
- = Practical layout with toilet facilities
- = Split level offering a practical layout

THE FEATURES

- = Great exposure to passing traffic
- = Existing sandwich and juice store with kitchen facilities
- = Sunlit and spacious throughout

Price : \$ 1,400
Building Size : 132 sqm
View : <https://www.trueproperty.com.au/lease/nsw/inner-west/ashfield/commercial/retail/3172081>



Michael Catalano
8507 2444

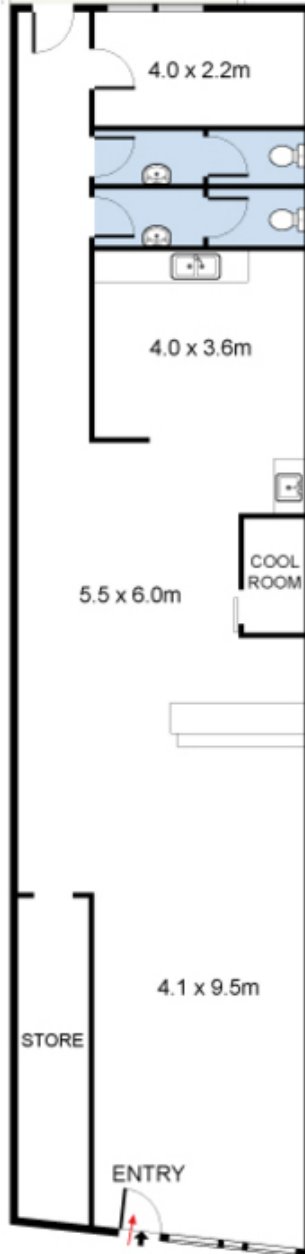
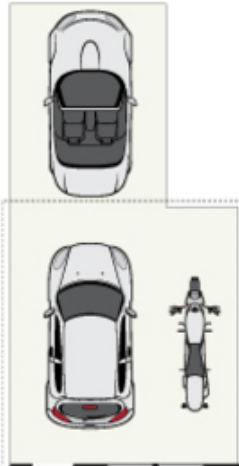

GROUND FLOOR

true =
PROPERTY

222 Liverpool Road, Ashfield

INT: 132 m²

DISCLAIMER: PLANS SHOWN ARE FOR PRESENTATION PURPOSES AND ARE NOT PART OF ANY LEGAL DOCUMENT. ALL MEASUREMENTS AND FIGURES ARE APPROXIMATE.