



12/176-180 Salisbury Road Camperdown NSW

1 1 1

This stylish contemporary apartment makes this home the ultimate executive retreat on the city fringe. This apartment comprises of all the modern conveniences with sleek finishes throughout.

- = One double sized bedroom, with mirrored built-in wardrobe
- = Separate study area and tiled and spacious bathroom
- = Security registered car space and internal laundry facilities
- = Stylish granite kitchen with gas cooking and ample storage
- = Open plan living and dining leading to a covered balcony
- = Located within just moments' walk to the always vibrant King Street Newtown offering scrumptious cafes and eateries, impressive specialty stores, shopping facilities, The University of Sydney, RPA hospital and access train

Land Size : 80 sqm
View : <https://www.trueproperty.com.au/sale/nsw/inner-west/camperdown/residential/apartment/6570546>



Michael Catalano
8507 2444

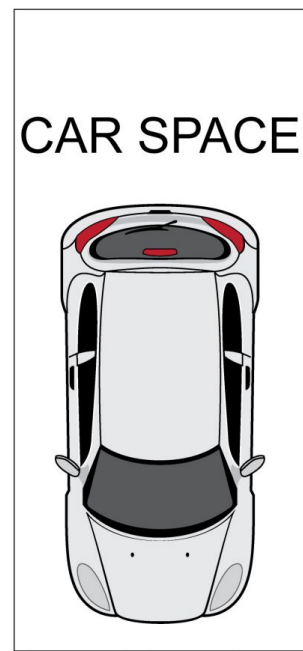
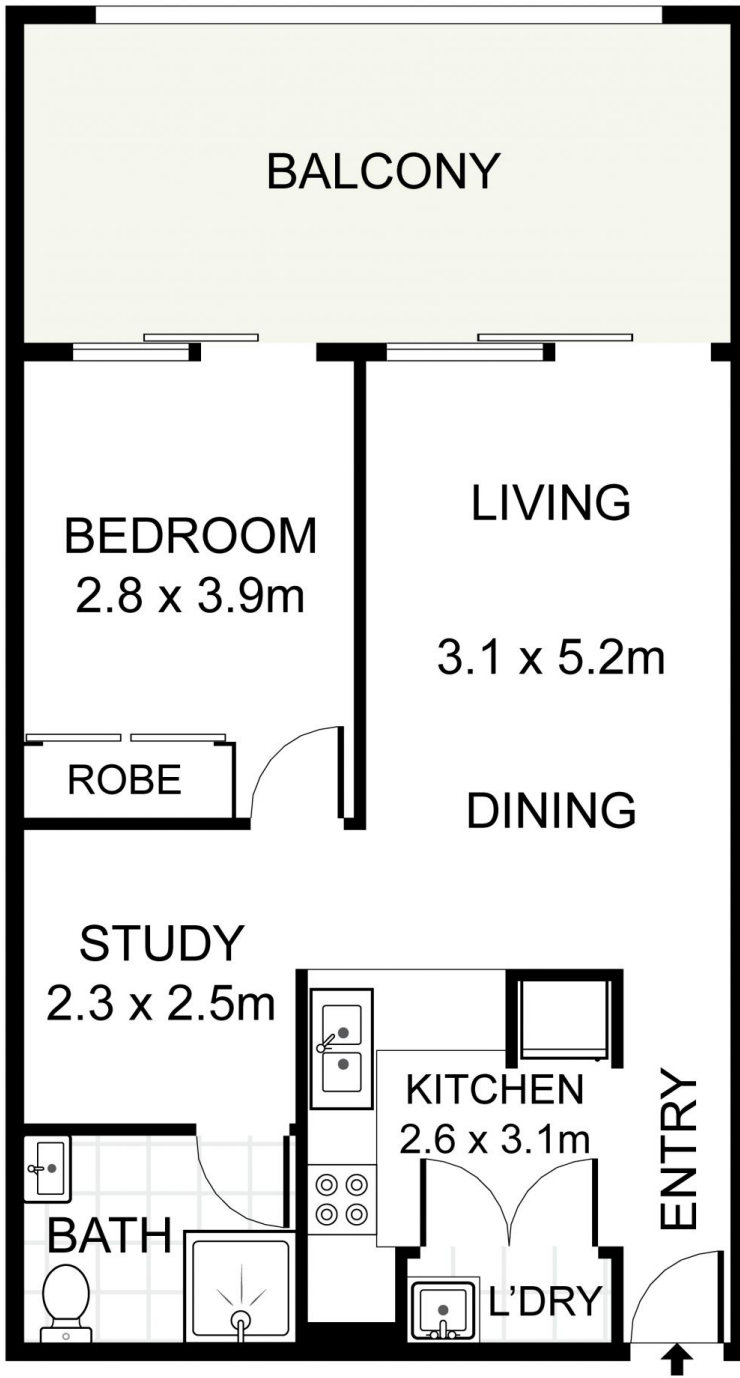

true =
PROPERTY

12/176-180 Salisbury Road, Camperdown

DISCLAIMER: PLANS SHOWN ARE FOR PRESENTATION PURPOSES AND ARE NOT PART OF ANY LEGAL DOCUMENT. ALL MEASUREMENTS AND FIGURES ARE APPROXIMATE.