



18/176-180 Salisbury Road Camperdown NSW

2 2 1

Peacefully and privately positioned at the rear of the complex, this apartment boasts spacious interiors and quality finishes throughout making this home the ultimate executive retreat on the city fringe. This apartment comprises all the modern conveniences with sleek finishes throughout. Perfectly located just moments to CBD transport, RPA hospital, expansive park lands, trendy cafes and award winning restaurants.

THE PROPERTY

- = Two generous bedrooms including built in wardrobes
- = Master bedroom with en-suite including bathtub
- = Large second tiled bathroom
- = Security registered car space
- = Huge light filled air conditioned combined open plan living and dining area flowing to a generously sized balcony
- = Separate gourmet gas kitchen with stone bench tops,

Price : \$ 900,000
Land Size : 95 sqm
View : <https://www.trueproperty.com.au/sale/nsw/inner-west/camperdown/residential/apartment/7597828>



Michael Catalano
8507 2444



Nicholas Ellias
02 8507 2444

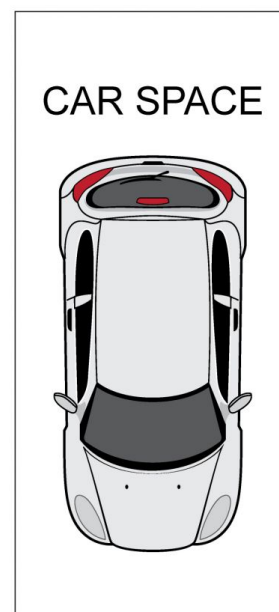
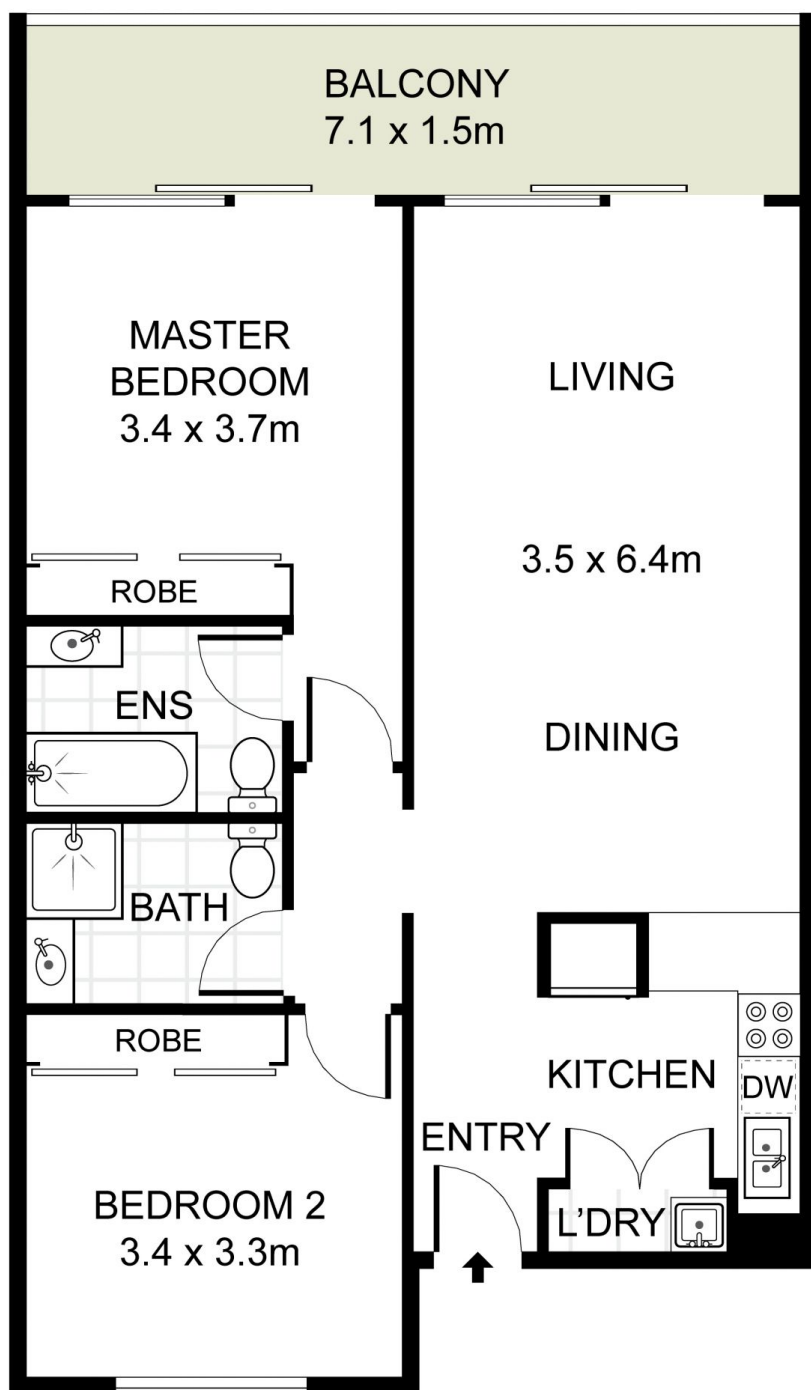

BASEMENT

LEVEL ONE

true =
PROPERTY

18/176 Salisbury Road, Camperdown

DISCLAIMER: PLANS SHOWN ARE FOR PRESENTATION PURPOSES AND ARE NOT PART OF ANY LEGAL DOCUMENT. ALL MEASUREMENTS AND FIGURES ARE APPROXIMATE.