



16/15 Erskineville Road Newtown NSW

1 1 1

A contemporary development set in the area's most desirable suburb, this faultless City-Fringe home is the perfect offering for an easy-care and convenient lifestyle. Bathed in Northern light the home's crisp interiors and effortless floor plan ensure a stylish and relaxed atmosphere. A short stroll to King Street attractions and Newtown and Erskineville rail station, become immersed in appeal of Inner-City living.

- = One large bedroom with built-in wardrobe
- = One modern tiled bathroom
- = One secure car space
- = Gourmet gas kitchen with dishwasher, ample storage and plenty of bench space
- = Large open plan living leading to entertainers balcony with park views
- = Internal laundry with dryer and ducted air-conditioning

Price : \$ 755,000
Land Size : 94 sqm
View : <https://www.trueproperty.com.au/sale/nsw/inner-west/newtown/residential/apartment/7784945>



Michael Catalano
8507 2444

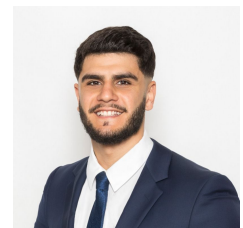

Nicholas Ellias
02 8507 2444

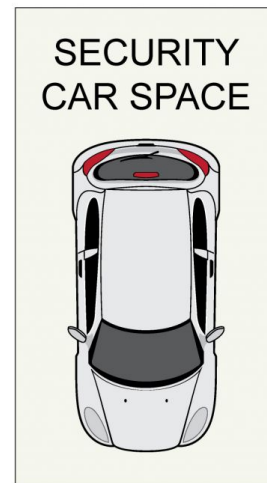
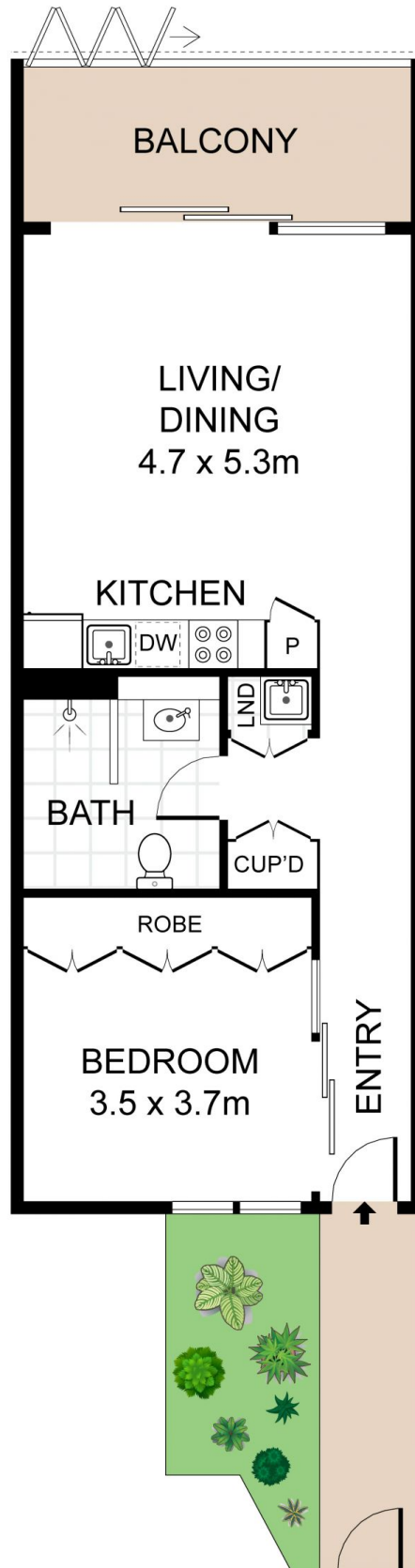

GROUND LEVEL

true[®]

16/15 Erskineville Road, Newtown

DISCLAIMER: PLANS SHOWN ARE FOR PRESENTATION PURPOSES AND ARE NOT PART OF ANY LEGAL DOCUMENT. ALL MEASUREMENTS AND FIGURES ARE APPROXIMATE.