



## 9 Copeland Street Alexandria NSW

2 🏠 1 🚗

Step into serene urban living with this charming 2 bedroom parkside residence. Nestled across from Erskineville Oval in a peaceful neighborhood, this home offers a perfect blend of contemporary comfort and natural beauty. Whether you're looking to downsize, start a family, or invest in a prime location, this residence offers the perfect opportunity to embrace a peaceful yet connected lifestyle.

**Type** : House  
**Price** : \$ 1,630,000  
**View** : <https://www.trueproperty.com.au/sale/nsw/eastern-suburbs/alexandria/residential/house/8053649>

- = Two bedrooms, both include wardrobes
- = Enjoy the luxury of a recently updated bathroom designed for relaxation and rejuvenation.
- = The kitchen boasts modern appliances and sleek countertops, perfect for culinary enthusiasts.
- = Separate living and dining areas
- = Step outside to your north facing private leafy courtyard,



**Michael Catalano**  
02 8507 2444



**Nicholas Ellias**  
02 8507 2444

[For full version visit the website](https://www.trueproperty.com.au)

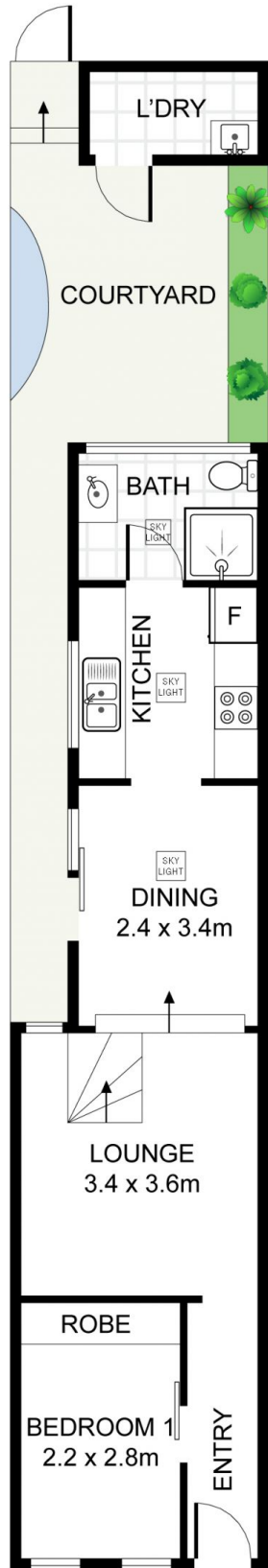

GROUND LEVEL

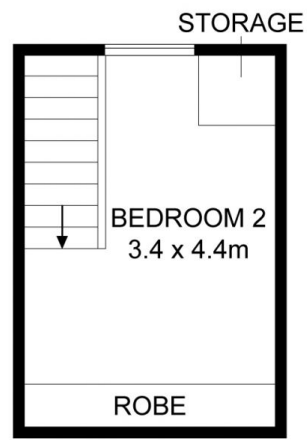

FIRST LEVEL



## 9 Copeland Street, Alexandria



DISCLAIMER: PLANS SHOWN ARE FOR PRESENTATION PURPOSES AND ARE NOT PART OF ANY LEGAL DOCUMENT. ALL MEASUREMENTS AND FIGURES ARE APPROXIMATE.